

Project Site Area

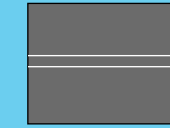

Roadway & double line marking to encourage use of roundabouts.



New on-street parking & kerb.

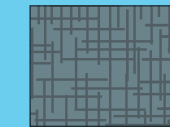

On-road threshold treatment to help reduce traffic speed.

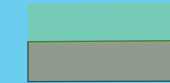

New footpaths with grassed verge.



New formal pedestrian zebra crossing.

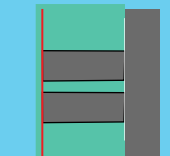

Existing driveways with grassed verge.

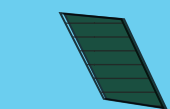

Proposed new streetscape gardens/rain gardens.



Proposed new street trees.



Proposed new low seating walls as informal gathering space.



Existing footpath.



N

20m

September 2022

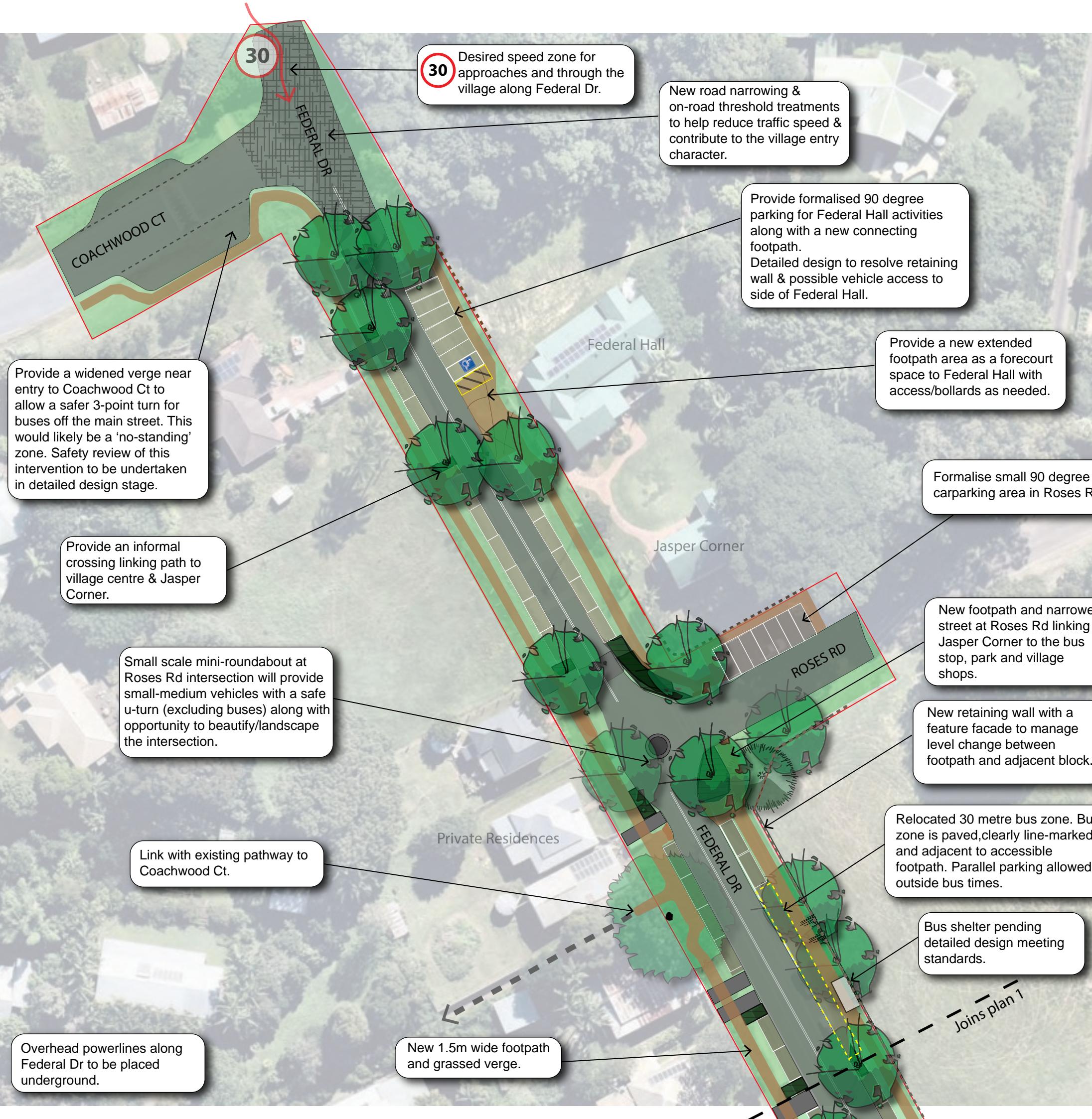
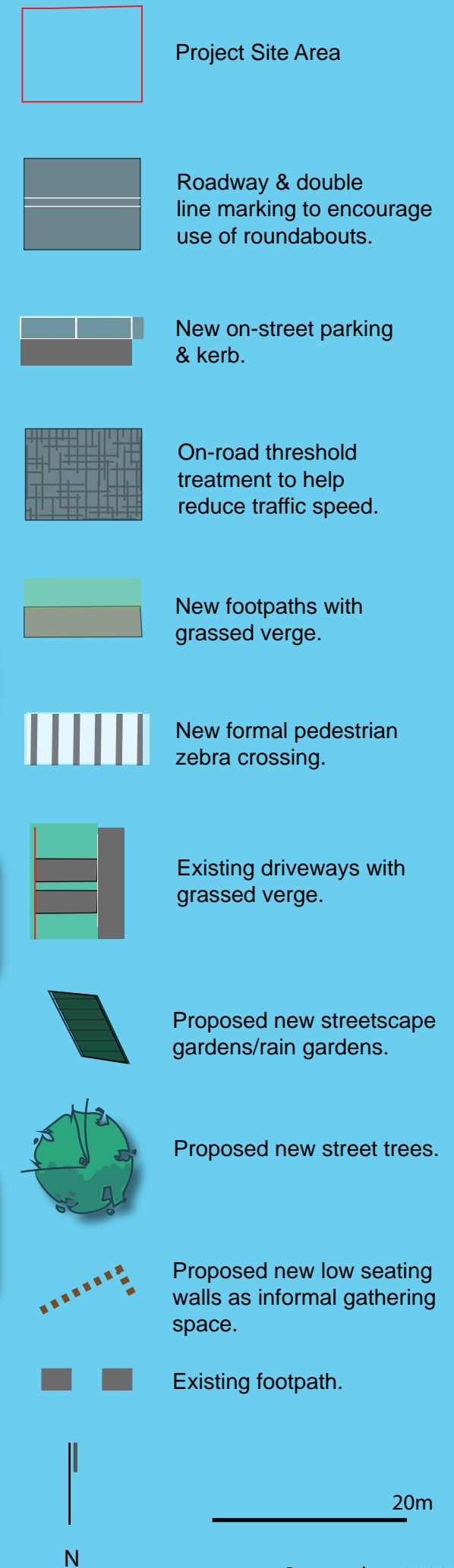

Exposed aggregate coloured concrete footpaths.



Paving and gravel to on-street parking areas.



Stamped asphalt on-road treatment as threshold traffic calming and place-making.



Local basalt walls as retaining and seating walls.



Recycled timber railway sleepers as feature seating



Informal gravel parking near tennis courts.



PLAN 3



Highly accessible pedestrian crossing
with surrounding landscape.



Rain gardens and trees in landscaped
kerb build-outs.



Lighting



Incorporate any required street lighting in a considered way.

Landscaping



Provide a high quality locally native landscape to the roundabout island ensuring sightlines & maintenance are considered.

Landscaping



Use a mature locally appropriate tree or similar as a central feature ensuring depth of planting medium and root zone protection.

Lighting



Consider inclusions of aesthetic landscape lighting or allowance for future installations.



Key Functional Description : Roundabout

- To allow for bus u-turns/turning.
- To provide for central pedestrian refuges on Binna Burra Road.
- To provide associated adjacent footpath/kerb ramps to safely connect pedestrians across Binna Burra Rd.

Signage



Ensure any required regulatory signage considers place-making elements.

Maintenance



Consider maintenance requirements with extended apron areas for safe access.

Thresholds



On-road threshold treatments to all entry/exit legs of the roundabout - consider stamped asphalt.

Aprons



Apron design to consider finishes & treatments that promote long life visual quality - eg. consider dark colours to reduce tyre marks.